

MAIN COMPONENT PARTS

1. Safety brake (permanently closed position)
2. Electromechanical linking device
3. Interface housing
4. Power supply and control box
5. Torque limiter

Note : A or B mounting position

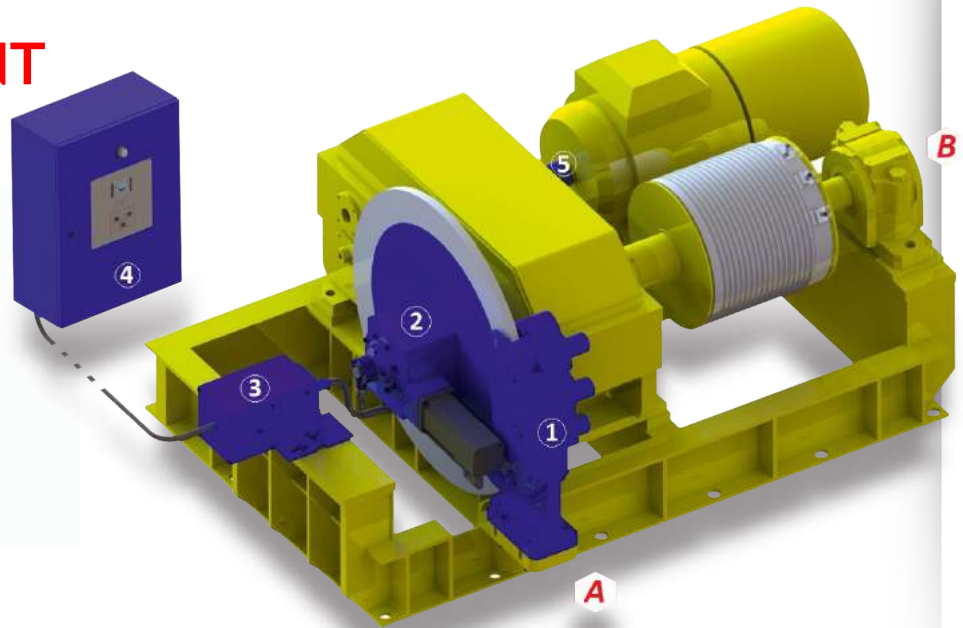

CRITICAL EVENTS

- Overspeed LS, HS, ...
- Winch component failure
- Unexpected movement from static position
- Unexpected contrary movement
- Load anchoring
- ...

Note : All monitoring fonctions available (optional)

CE CONFORMITY INFORMATION

- 2006/42/CE Directive machine
- 2006/95/CE Directive BT
- 2004/108/CE Directive CEM
- NF EN 13135 Appareil de levage à charge suspendue
- NF EN 13849 Sécurité des machines
- NF EN 62061 Sécurité des machines
- NF EN 62508 Lignes directrices relatives aux facteurs humains

CONTACT

FOC TRANSMISSIONS
17-19 rue du 11 novembre • 38200 Vienne
Tél. +33 (0)4 74 53 25 90
Fax +33 (0)4 74 31 92 50
accueil@foc-transmissions.fr
www.foc-transmissions.fr tél. +33 (0)4 74 53 25 90

- Fax +33 (0)4 74 31 92 50

THE SAFETY DEVICE FASTBRAKE®

- Detects any uncontrolled potentially dangerous movement of the load.
- Insures instant braking no overspeed and extremely short stopping distance.
- Limits critical stresses and keep stresses to the complete winch device within design tolerances.
- Provides flexible realtime monitoring and recording of operating data for maintenance and checking purposes.
-

COMPARATIVE SAFETY

between Fastbrake® and standard braking device during a critical event

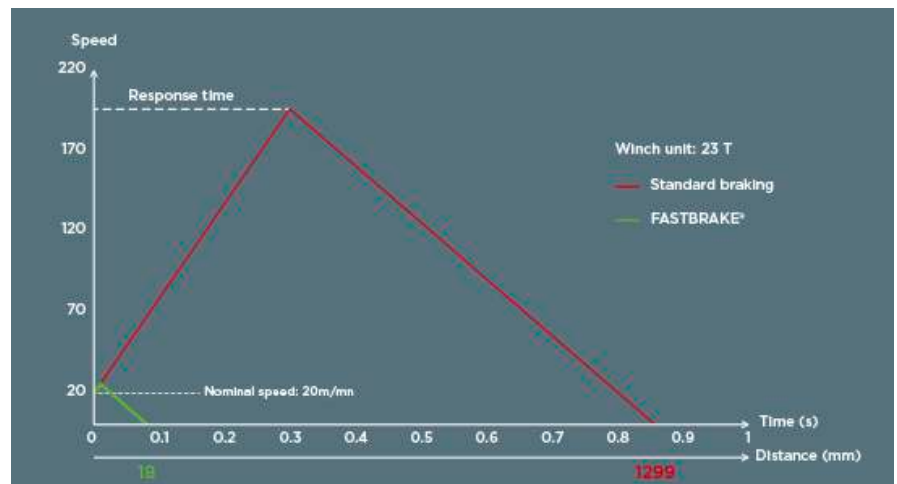

FASTBRAKE® RANGE PERFORMANCE

SIZE	FB 0	FB 1	FB 2	FB 3	FB 4	FB 5	FB 6	FB 7	FB 8
<i>Braking torque</i>									
Braking torque (N.m)	3797	8722	18264	28800	52200	76080	134848	247200	504000
<i>Performance example</i>									
Drum nominal torque (N.m)	2373	5451	11415	18000	32625	47550	84279	154500	315000
Selected drum speed (tr/min)	67	67	67	67	67	67	67	67	67
Ø selected drum diameter (mm)	350	400	450	500	550	600	700	800	1000
Selected reeving	2	2	4	4	4	6	6	6	6
ML (T)	3	5	20	29	47	95	144	232	378
Obtained lifting speed (m/min)	37	42	24	26	29	21	24	28	35

OTHER FEATURES

- **Operating environment:** Temperature range -10 to 55 °c Humidity ≤ 90%
- **IP Protections:** Control box IP 66, Encoder IP 65, Motor IP 64
- **Operating voltage:** AC 380V +/- 10% 50-60Hz
- **Classifying:** Category 2 PL=d according NF EN 13849
- **Maintenance:** Oil-less operation, no wearing parts
- **Mounting:** fitted with drum shaft spines

SPACES REQUIREMENTS

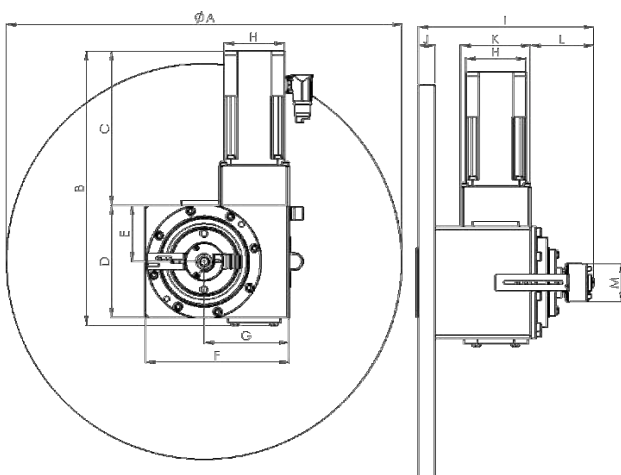

- **Power supply and control box:** 800*600*300
- **Interface housing:** 130*130*210

SIZE	FB 0	FB 1	FB 2	FB 3	FB 4	FB 5	FB 6	FB 7	FB 8
A	550	570	640	685	755	840	930	1105	1280
B	378	412	462	491	535	602	669	771	870
C	237	234	237	234	235	256	242	243	243
D	133	170	217	249	292	338	419	521	619
E	66,5	85	108,5	124,5	146	169	209,5	260,5	309,5
F	178	218	264	302	353	401	484	607	732
G	107	129	150	172	202	226	268	340	415
H	91	91	91	91	91	100	100	100	100
I	249	265	268	283	288	300	208	365	429
J	20	25	30	30	30	30	30	35	40
K	99	106	110	120	135	143	155	195	237
L	87	95	91	100	98	99	100	100	110
M	59	59	59	59	59	59	59	59	59

DRUM SHAFT SPINE DIMENSIONS

SIZE	FB 0	FB 1	FB 2	FB 3	FB 4	FB 5	FB 6	FB 7	FB 8
Spines (NF 22-141)	60*22*2.5	65*24*2.5	80*30*2.5	100*18*5	110*20*5	110*20*5	130*24*5	180*34*5	220*27*7.5